

REV.	E/CN NO.	DESCRIPTION	DATE	DESIGN
A	---	INITIAL RELEASED	2019.07.30	Hank.Pei
B	---	MODIFY MOLDING STRUCTURE CHART	2020.03.24	Neo Liu

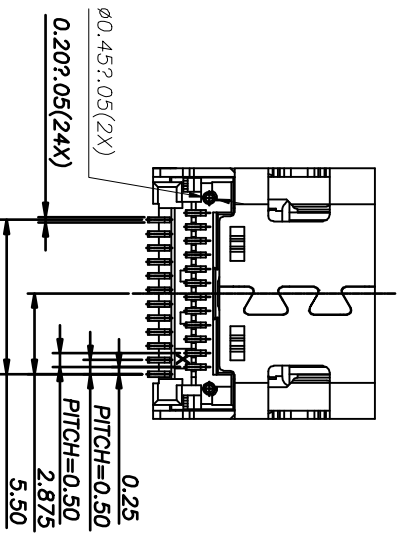
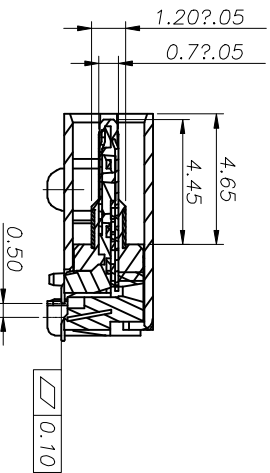
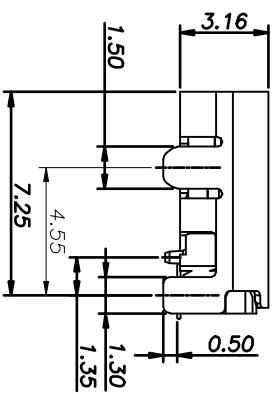
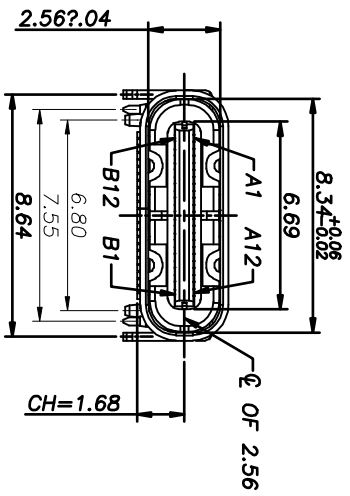
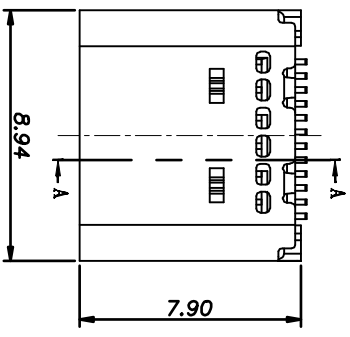
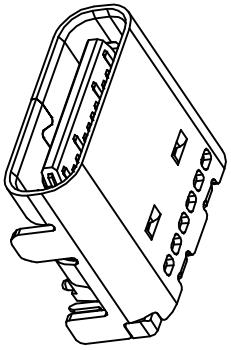

NOTE:

- MATERIAL SPECIFICATION:
 - HOUSING:HIGH TEMPERATURE RESISTANT PLASTIC(LCP),UL94 V-0.
 - CONTACTS:COPPER ALLOY(C1814)
 - MID PLATE&EMI PLATE: STAINLESS STEEL(SUS301)
 - FRONT SHELL: STAINLESS STEEL(SUS304)
- PLATING SPECIFICATION:
 - CONTACTS:
 - 50u" MIN. UNDER PLATED OVER ALL.
 - AU PLATED ON THE FUNCTIONAL AREA OF CONTACT. (GOLD PLATING THICKNESS FOLLOW THE P/N)
 - FRONT SHELL:
 - 30u" MIN. UNDER PLATED OVER ALL.
 - 30u" MIN. UNDER PLATED OVER ALL.
 - MID PLATE:
 - 30u" MIN. UNDER PLATED OVER ALL.
 - 80u"MIN. PLATED OVER ALL
 - EMI PLATE:
 - CLEAR ONLY
- MECHANICAL PERFORMANCE,
 - INSERTION FORCE: 0.5~2.0kgf.
 - REMOVAL FORCE: 0.8kgf~2.0kgf.
 - DURABILITY: 10000 CYCLES.
- ELECTRICAL PERFORMANCE,
 - CURRENT RATING:5.0A VOLTAGE RATING:5.0V
 - LCR: VBUS & GND PINS AND OTHER PINS: 40mΩ/PIN MAX. SHIELD: 50mΩ/MAX. LCR MAX. CHANGE OF ALL PINS: 10mΩ.
 - INSULATION RESISTANCE: 100MΩ MIN
 - DIELECTRIC WITHSTAND VOLTAGE:AC 100V FOR 1 MINUTE.
- ENVIRONMENTAL PERFORMANCE:
 - OPERATING TEMPERATURE: -25#~+85#.
 - IR REFLOW: THE PEAK TEMPERATURE ON THE BOARD SHALL BE MAINTAINED FOR 10 SECONDS AT 260°C.

TOLERANCE		NAME:(INTENDED USE) CUSTOMER DRAWING		DRAWG NO.	
X.X ±0.30	X' ±10'	PART NO.		TITLE: USB CF 24PIN SMT TYPE TOP MOUNT	
.XX ±0.20	X' ±8'	SEE TABLE1		SCALE SHEET REV.	
XXX ±0.10	.XX ±5'	DESIGN: Neo Liu		1:1 1/3 B	
UNITS	mm	CHED:		GAP-ACF006-5R	
MATERILA	---	APPD:		---	
FINISH	---	---		---	



6 5 4 3 2 1

REV.	E.CN. NO.	DESCRIPTION	DATE	DESIGN
A	---	INITIAL RELEASED	2019.07.30	Hank.Pei
B	---	MODIFY MOLDING STRUCTURE CHART	2020.03.24	Neo Liu

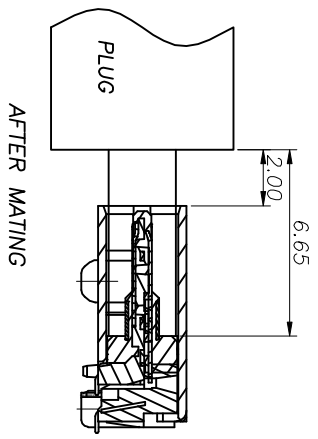

USB TYPE-C PIN ASSIGNMENTS

PIN NUMBER	SIGNAL NAME	PIN NUMBER	SIGNAL NAME
A1	GND	B12	GND
A2	SSTXp1	B11	SSRXp1
A3	SSTXn1	B10	SSRXn1
A4	VBUS	B9	VBUS
A5	CC1	B8	SBU2
A6	Dp1	B7	Dn2
A7	Dn1	B6	Dp2
A8	SBU1	B5	CC2
A9	VBUS	B4	VBUS
A10	SSRXn2	B3	SSTXn2
A11	SSRXp2	B2	SSTXp2
A12	GND	B1	GND

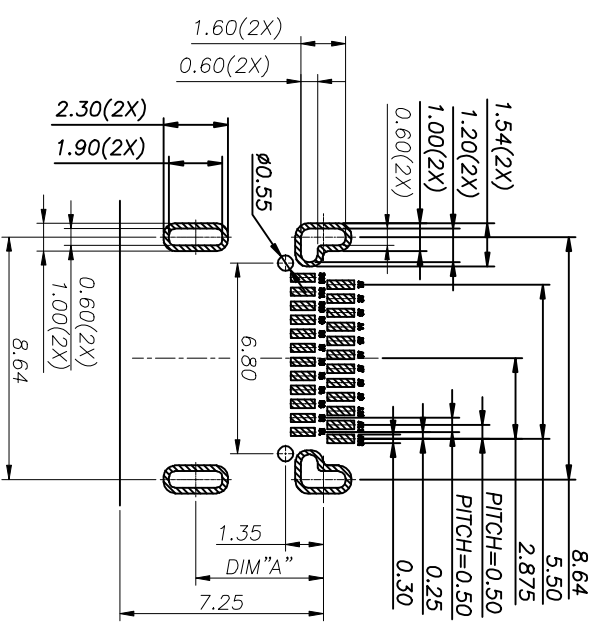

RECOMMENDED PCB LAYOUT(TOP VIEW)
THICKNESS 0.60MM;DEFAULT TOLERANCE:±.05

ORDER INFORMATION

P/N: ACF006-5A1H1A1XX-0HR

HOUSING MATERIAL
A: LCP
E: PA10T

HOUSING COLOR
1: BLACK

SHELL PLATING
1: Ni
CONTACT MATERIAL
A: C1814

CONTACT FUNCTIONAL AREA PLATED
03: Au 3u"
15: Au 15u"
30: Au 30u"

CONTACT SOLDER AREA PLATED
1: Au 1u"

TOLERANCE	NAME(INTENDED USE) CUSTOMER DRAWING	DRAWG NO.	SCALE
X.X ±0.30 X' ±10'	PART NO.	SEE TABLE1	1:1
.XX ±0.20 X' ±8'	DESIGN: Neo Liu		2/3
XXX ±0.10 .XX' ±5'	CHED:		B
UNITS mm	APPD:		
MATERILA			
FINISH			



TITLE: USB CF 24PIN SMT TYPE
TOP MOUNT

GAP-ACF006-5R

REV. B

REV.	ECN NO.	DESCRIPTION	DATE	DESIGN
A	---	INITIAL RELEASED	2019.07.30	Hank.Pei
B	---	MODIFY MOLDING STRUCTURE CHART	2020.03.24	Neo Liu

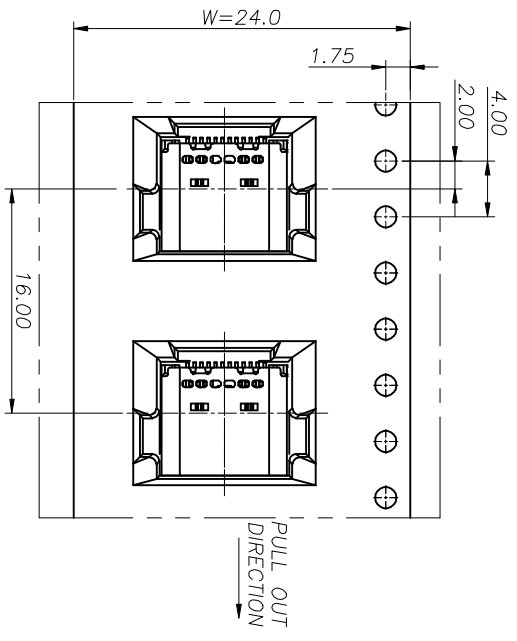
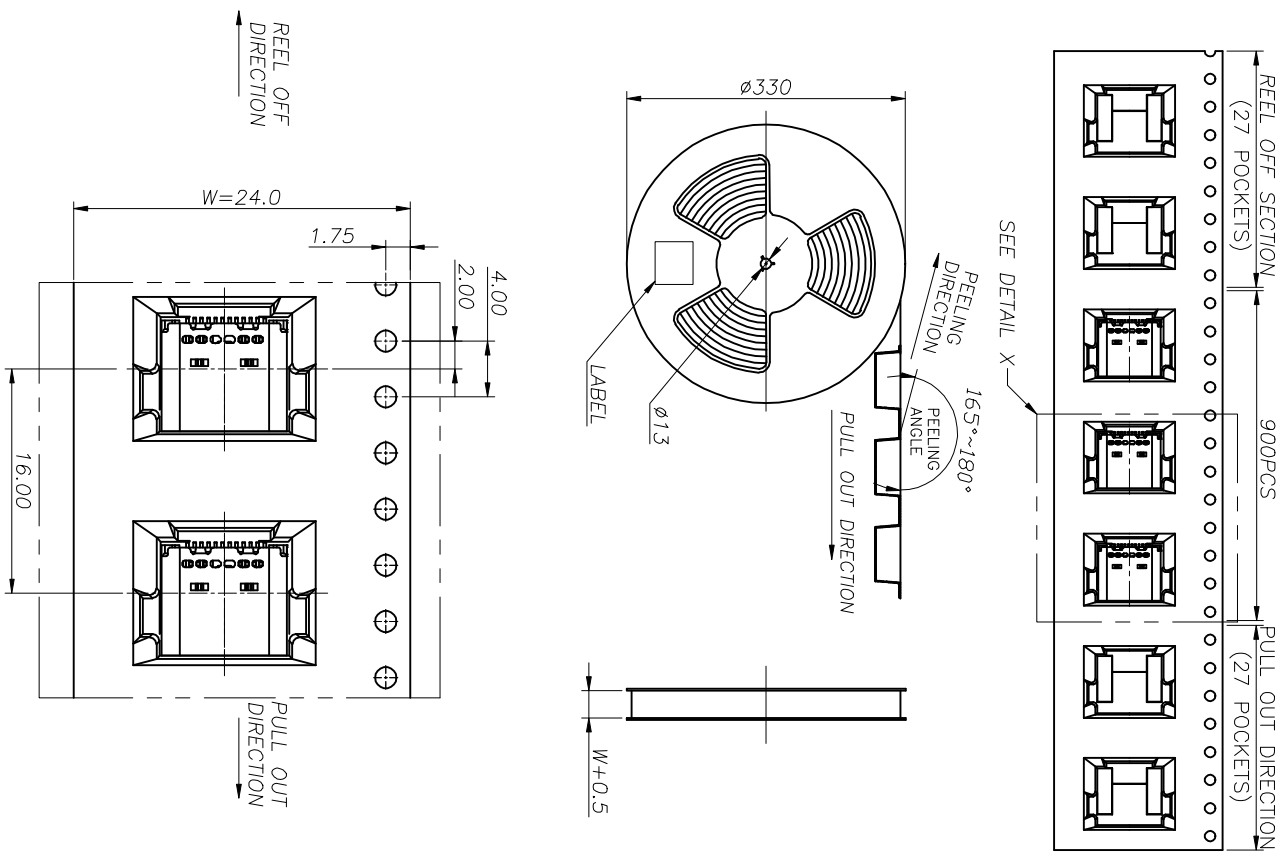
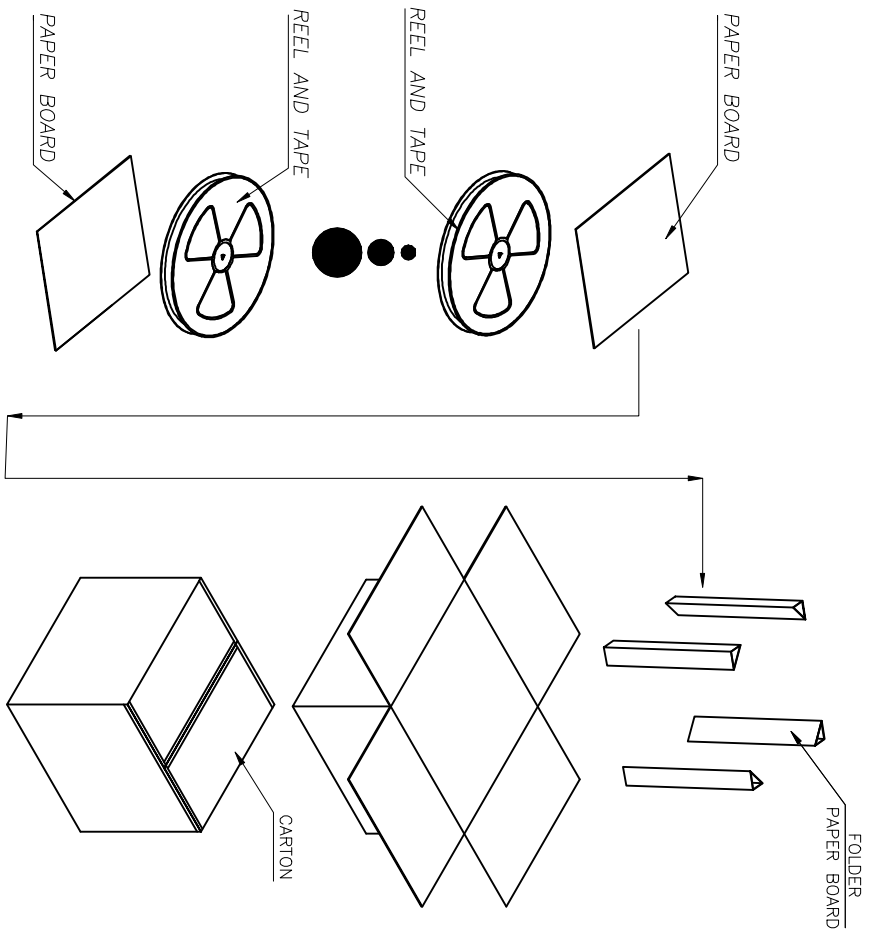

TOLERANCE		NAME(INTENDED USE)		DRAWG NO.	
X.X	±0.30	X.X	±10'	GAP-ACF006-5R	
XX	±0.20	X.X	± 8'	SCALE SHEET	
.XXX	±0.10	.XX	± 5'	1:1	
UNITS	mm	DESIGN:	Neo Liu	3/3	
MATERILA	---	CHED:	---	REV.	
FINISH	---	APPD:	---	B	
CONNECTOR (PCS)		REEL	CARTON		
900		9000			
TITLE: USB CF 24PIN SMT TYPE TOP MOUNT				Goldconn	